

TOP VIEW

SPECIFICATIONS	
MANUFACTURER:	CLEANAWATER
MODEL:	TS 3000 SS
CONSTRUCTION MATERIAL (SHELL):	1.2MM #304 STAINLESS STEEL
CONSTRUCTION MATERIAL (LID):	1.2MM #304 STAINLESS STEEL
NOMINAL FLOW RATE:	0.83L PER SECOND (3000L/HR)
MAXIMUM LOADING:	1.67L PER SECOND (6000L/HR)
WASTE WATER INLET:	DN40 BSPF
WASTE WATER OUTLET:	DN50 BSPF
WASTE OIL OUTLET:	38MM OD TUBE
SLUDGE OUTLETS:	DN40 BSPF
WATER CAPACITY:	654 LITRES
DRY WEIGHT:	100 KG
OPERATING WEIGHT:	760 KG
PUMP:	DIAPHRAGM/HELICAL ROTOR

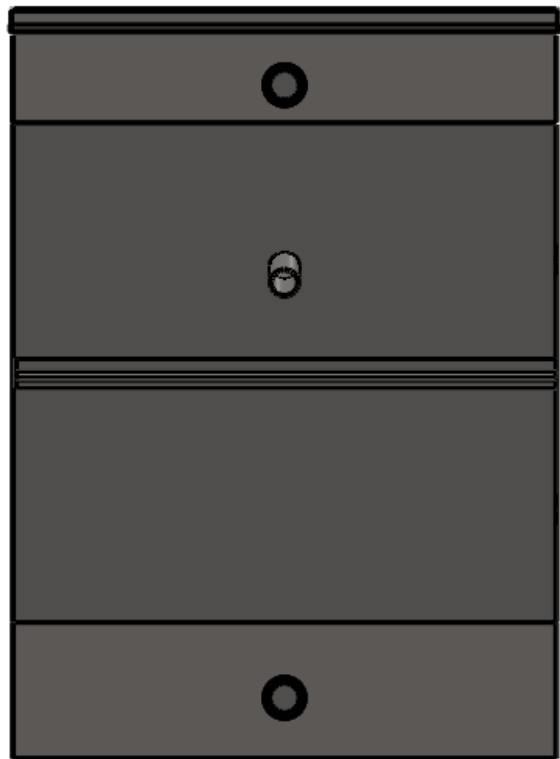

FRONT VIEW



RIGHT ELEVATION

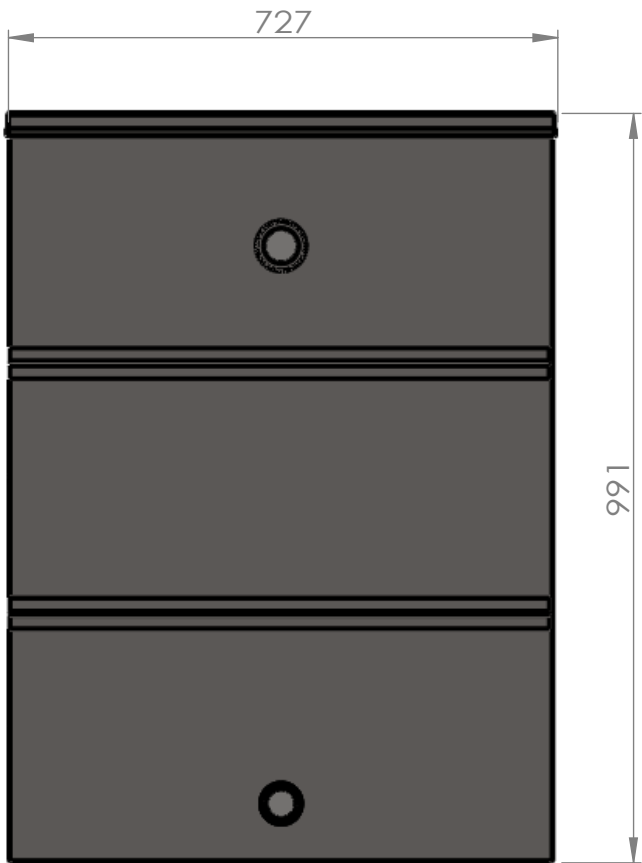

REAR VIEW



TITLE: TS 3000 SS OIL WATER SOLIDS SEPARATOR	DWG NO. AA - 009				UNLESS OTHERWISE SPECIFIED: DIMENSIONS ARE IN MILLIMETERS SURFACE FINISH: TOLERANCES: LINEAR: ANGULAR:	MATERIAL: STAINLESS STEEL	WEIGHT: 100 KG		NAME	SIGNATURE	DATE	REVISION	DEBUR AND BREAK SHARP EDGES	PROPRIETARY AND CONFIDENTIAL THE INFORMATION CONTAINED IN THIS DRAWING IS THE SOLE PROPERTY OF CLEANAWATER. ANY REPRODUCTION IN PART OR AS A WHOLE WITHOUT THE WRITTEN PERMISSION OF CLEANAWATER IS PROHIBITED.
	SHEET 1 OF 1	SCALE: n/a	A3	DO NOT SCALE DRAWING				DRAWN	J.S		5/2013	FINISH:		
								CHK'D	R.D		5/2013			